

NOTICE OF MEETING

LICENSING SUB COMMITTEE

Tuesday, 23rd July, 2024, 7.00 pm - Microsoft Teams (watch the live meeting [here](#) and watch the recording [here](#))

Members: Councillors Anna Abela (Chair), Mark Blake and Nick da Costa

Quorum: 3

1. FILMING AT MEETINGS

Please note this meeting may be filmed or recorded by the Council for live or subsequent broadcast via the Council's internet site or by anyone attending the meeting using any communication method. Members of the public participating in the meeting (e.g. making deputations, asking questions, making oral protests) should be aware that they are likely to be filmed, recorded or reported on. By entering the 'meeting room', you are consenting to being filmed and to the possible use of those images and sound recordings.

The Chair of the meeting has the discretion to terminate or suspend filming or recording, if in his or her opinion continuation of the filming, recording or reporting would disrupt or prejudice the proceedings, infringe the rights of any individual, or may lead to the breach of a legal obligation by the Council.

2. APOLOGIES FOR ABSENCE

To receive any apologies for absence.

3. URGENT BUSINESS

The Chair will consider the admission of any late items of Urgent Business. (Late items will be considered under the agenda item where they appear. New items will be dealt with under item 7 below).

4. DECLARATIONS OF INTEREST

A member with a disclosable pecuniary interest or a prejudicial interest in a matter who attends a meeting of the authority at which the matter is considered:

- (i) must disclose the interest at the start of the meeting or when the interest becomes apparent, and
- (ii) may not participate in any discussion or vote on the matter and must withdraw from the meeting room.

A member who discloses at a meeting a disclosable pecuniary interest which is not registered in the Register of Members' Interests or the subject of a pending notification must notify the Monitoring Officer of the interest within 28 days of the disclosure.

Disclosable pecuniary interests, personal interests and prejudicial interests are defined at Paragraphs 5-7 and Appendix A of the Members' Code of Conduct

5. SUMMARY OF PROCEDURE

The Sub-Committee will first hear from the Licensing Officer. After that, the applicant will present their application and the Sub-Committee and objectors will have the opportunity to ask questions. Then, the objectors will present their case and the Sub-Committee and objectors will have the opportunity to ask questions.

All parties will then have the opportunity to sum up, and then the meeting will conclude to allow the Sub-Committee to deliberate and reach a decision. This decision will then be provided in writing within five working days of this meeting.

6. APPLICATION FOR A NEW PREMISES LICENCE AT BRUCE BURGERS, 93 BRUCE GROVE, TOTTENHAM, LONDON, N17 6UZ (BRUCE CASTLE) (PAGES 1 - 54)

To consider an application for a new premises licence.

7. NEW ITEMS OF URGENT BUSINESS

To consider any items of urgent business as identified at item 3.

Nazyer Choudhury, Principal Committee Co-ordinator
Tel – 020 8489 3321
Fax – 020 8881 5218
Email: nazyer.choudhury@haringey.gov.uk

Fiona Alderman
Head of Legal & Governance (Monitoring Officer)
George Meehan House, 294 High Road, Wood Green, N22 8JZ

Monday, 15 July 2024

Report for: Licensing Sub Committee 23rd July 2024

Item number: 6

Title: Application for a New Premises Licence At Bruce Burgers, 93 Bruce Grove, Tottenham, London, N17 6UZ.

Report authorised by : Daliah Barrett-Licensing Team Leader – Regulatory Services

Ward(s) affected: Bruce Castle

Report for Key/Non Key Decision: Not applicable

1. Describe the issue under consideration

1.1 This report relates to an application for a new premises licence by : Pindy Kaur under the company name of Bruces Burgers Ltd.

1.2 The application seeks the following:

Regulated Entertainment: Recorded Music

Monday to Sunday 2300 to 0100 hours

Late Night Refreshment

Monday to Sunday 2300 to 0100 hours

Sale of Alcohol

Monday to Sunday 1700 to 0100 hours

Supply of alcohol **ON** the premises.

Hours open to Public

Monday to Sunday 1700 to 0100 hours

1.3 The application can be found at - **Appendix A.**

1.4 Representations have been received from:

Met Police- App B

Licensing Authority RA – App C.

There are representations from residents in support of the variation. – App D

Representations against the variation – App E.

Planning Information - App F

1.5 Recommendation

In considering the representations received and what is appropriate for the promotion of the licensing objectives, the steps the Sub-Committee can take are:

- Grant the application as requested
- Grant the application whilst imposing additional conditions and/or altering in any way the proposed operating schedule.
- Exclude any licensable activities to which the application relates

- Reject the whole or part of the application

Members of the licensing sub committee are asked to note that they may not modify the conditions or reject the whole or part of the application merely because it considers it desirable to do so. It must be appropriate in order to promote the licensing objectives.

2 Background

- 2.1 The premises is situated in a terrace of shops with residential above in front and behind the venue. There is a rear garden area that is included in the plan submitted.
- 2.2 The Planning Officer has advised that the current planning permission are as follows and that any increase in those hours will require an application to Planning for a change in the conditions:
- “2. The use hereby permitted shall not be operated before 08:00 or after 23:30 hours on Monday to Saturday and not before 0800 or after 2300 hours on Sundays or Bank Holidays. Reason: This permission is given to facilitate the beneficial use of the premises whilst ensuring that the amenities of adjacent residential properties are not diminished.
- 3 No detriment to the amenity of the neighbourhood shall be caused by noise or other disturbance than is reasonable as a result of the use of the premises hereby authorised. Reason: To ensure that the proposal does not prejudice the enjoyment of neighbouring occupiers of the properties.
4. No music, live concerts or other amplified sound shall emanate from the site which, in the opinion of the Environmental Health Service acting on behalf of the Local Planning Authority, cause nuisance to any adjacent occupiers at any time. Reason: To ensure the proposed development does not impinge on the amenities of adjacent occupiers.”
- 2.3 The applicant has been advised of the Planning requirements to submit an application for a change of use for the hors under Planning to be regularised. **App F**

3 Licensing Policy

- 3.1 The committee will also wish to be aware of the guidance issued under section 182 of the Licensing Act 2003. Licensing is about regulating the provision of licensable activities on licensed premises, by qualifying clubs and at temporary events within the terms of the Licensing Act 2003. The terms and conditions attached to various permissions are focused on matters which are within the control of individual licensees and others granted relevant permissions. Accordingly, these matters will centre on the premises and places being used for licensable activities and the vicinity of those premises and places.
- 3.2 The Section 182 Guidance that under pins the Licensing Act 2003 with regards to hours already in existence under the Planning regime:

“14.66 There are circumstances when, as a condition of planning permission, a terminal hour has been set for the use of premises for commercial purposes. Where these hours are different to the licensing hours, the applicant must observe the earlier closing time.”

- 3.3 The objective of the licensing process is to allow for the carrying on of retail sales of alcohol and the prevention of public nuisance, prevention of crime and disorder, public safety and protection of children from harm. It is the Licensing Authority's wish to facilitate well run and managed premises with licence holders

displaying sensitivity to the impact of the premises on local residents.

- 3.4 Cumulative impact has been used as a term to describe the street that a number of licensed premises can have on crime and disorder, nuisance and the impact on nearby residents. It is often not that licensed premises on their own are operating in a way that is detrimental to the licensing objectives, but it is the accumulation of the premises and the people attending them creates the increased problems and demands on services. Cumulative impact can occur either in the area where the premises are located or some distance away from them. The issue of cumulative impact occurs due the number of people in the area frequenting the licensed premises.
- 3.5 In considering licence applications, where relevant representations are made, this Licensing Authority will consider the adequacy of measures proposed to deal with the potential for public nuisance and/or public disorder having regard to all the circumstances of the case.
- 3.6 Where relevant representations are made, this authority will demand stricter conditions with regard to noise control in areas that have denser residential accommodation, but this will not limit opening hours without regard for the individual merits of any application. This authority will consider each application and work with the parties concerned to ensure that adequate noise control measures are in place. Any action taken to promote the licensing objectives will be appropriate and proportionate.
- 3.7 This Licensing Authority in determining what action to take will seek to establish the cause of concern and any action taken will be directed at these causes. Any action taken to promote the licensing objectives will be appropriate and proportionate.
- 3.8 Also The Licensing Authority may not impose conditions unless its discretion has been exercised following receipt of relevant representations and it is satisfied as a result of the hearing that it is appropriate to impose conditions to promote one or more of the four licensing objectives. Therefore conditions may not be imposed for the purpose other than promoting the licensing objectives and in some cases no additional conditions will be required.
- 3.9 In cases Members should make their decisions on the civil burden of proof, that is the balance of probability.
- 3.10 Members should consider in all cases whether or not primary legislation is the appropriate method of regulation and should only consider licence conditions when the circumstances in their view are not already adequately covered elsewhere.
- 3.11 The Government has advised that conditions must be tailored to the individual type, location and characteristics of the premises and events concerned. Conditions cannot seek to manage the behaviour of customers once they are beyond the direct management of the licence holder and their staff.
The Councils Licensing policy generally expects applicants to address the licensing objectives and discuss how to do this with the relevant responsible authorities.

4 Licensing hours

- 4.1 Where relevant representations are made, the Council will consider the proposed hours on their individual merits. Notwithstanding this, the Council may require stricter conditions in areas that have denser residential accommodation to prevent public nuisance. The Council will endeavour to work with all parties

concerned in such instances to ensure that adequate conditions are in place. The Council may restrict the hours that certain premises can offer alcohol for sale for consumption off the premises for preventing crime, disorder and nuisance.

5 Powers of a Licensing Authority

- 5.1 The decision should be made with regard to the Secretary of the State's guidance and the Council's Statement of Licensing Policy under the Licensing Act 2003. Where the decision departs from either the Guidance or the Policy clear and cogent reasons must be given. Members should be aware that if such a departure is made the risk of appeal / challenge is increased.
- 5.2 The licensing authority's determination of this application is subject to a 21 day appeal period or if the decision is appealed the date of the appeal is determined and /or disposed of.

6 Other considerations

Section 17 of the Crime and Disorder Act 1998 states:

"Without prejudice to any other obligation imposed on it, it shall be the duty of each authority to which this section applies to exercise its various functions with due regard to the likely effect of the exercise of those function on, and the need to do all that it reasonably can to prevent crime and disorder in its area".

6.1 Human Rights

While all Convention Rights must be considered, those which are of particular relevance to the application are:

- Article 8 – Right to respect for private and family life.
- Article 1 of the First Protocol – Protection of Property
- Article 6(1) – Right to a fair hearing.
- Article 10 – Freedom of Expression

7 Use of Appendices

Appendix A - New Application.

Appendix B – Met Police Representation

Appendix C – LA Representation

Appendix D - Representations in support of the application

Appendix E – Representations against the variation.

Appendix F – Planning information

Background papers: Section 82 Guidance

Haringey Statement of Licensing policy

Appendix A

This page is intentionally left blank



Start

Are you an agent acting on behalf of the applicant?: No

Applicant: Applicant details

Full name: Pindy Kaur

Email: [REDACTED]

Which legal structure are you applying as? A business or organisation including as a sole trader

Is your business registered in the UK? Yes

Is your business registered outside the UK?

Commercial register:

Registration number: 10367555

Business name: Bruce burgers ltd

Are you VAT registered?: No

VAT number:

Legal status: Private Limited Company

What is your position in the business?: Manager

Premises details

Premises or Trading name: Bruce Burgers

Please provide a postcode, OS Map Reference or description Address

Premises OS Map reference:

Address Description:

Full address of the premises: 93, Bruce Grove, Tottenham, Haringey, London, N17 6UZ

Do you have a rateable value based on VOA? Yes

What is the non-domestic rateable value band?: B (£4,301-£33,000)

Are you applying to only sell alcohol?:

NDR Fee to Pay: £190

Applicant 2: Application details

In what capacity are you applying for the premises licence? Limited company / limited liability partnership

Confirm the following: I am carrying on or proposing to carry on a business which involves the use of the premises for licensable activities

Non-individual applicant details

Full name: Bruce Burgers Ltd

Do you have a registration number?: Yes

Please enter your registration number: 10367555

Description of applicant: Restaurant based on bruce grove in tottenham.. the Restaurant is a limited company and is a family run bsuiness trading for over 6 years

[REDACTED]

Operating Schedule

When do you want the premises licence to start?: 01/07/2024

When do you want the premises licence to end?:

Please give a general description of the premises: Bruce burgers consists of a dining area at the front of the shop which can seat up to 25 people and then a kichen area and male and female toilets with a garden area at the rear of the restaurant which can seat up to 20 people

Do you expect more than 5,000 or more people to attend the premises at any one time?: No

How many people do you expect to attend the premises at any one time?:

Additional fee to be paid for over 5,000 capacity: £

Regulated entertainment

This section covers regulated entertainment

Provision of plays

Will you be providing plays?: No

Provision of films

Will you be providing films?: No

Provision of indoor sporting events

Will you be providing indoor sporting events?: No

Provision of boxing or wrestling entertainments

Will you be providing boxing or wrestling entertainments?: No

Provision of live music

Will you be providing live music?: No

Provision of recorded music

Will you be providing recorded music?: Yes

Which days of the week do you intent the premises to be used for the activity?Monday,

Tuesday, Wednesday, Thursday, Friday, Saturday, Sunday

Give timings in 24 hour clock. (e.g., 16:00) and only give details for the days of the week when you intend the premises to be used for the activity.:

Monday:

- Start 1: 23:00
- End 1: 01:00
- Start 2:
- End 2:

Tuesday:

- Start 1: 23:00
- End 1: 01:00
- Start 2:
- End 2:

Wednesday:

- Start 1: 23:00
- End 1: 01:00
- Start 2:
- End 2:

Thursday:

- Start 1: 23:00
- End 1: 01:00
- Start 2:
- End 2:

Friday:

- Start 1: 23:00
- End 1: 01:00
- Start 2:
- End 2:

Saturday:

- Start 1: 23:00
- End 1: 01:00
- Start 2:
- End 2:

Sunday:

- Start 1: 23:00
- End 1: 01:00
- Start 2:

- End 2:

Will the playing of recorded music take place indoors or outdoors or both? Both
State type of activity to be authorised, if not already stated, and give relevant further details.: Music will be played in the background

State any seasonal variations for playing of recorded music:

Non standard timings. Where the premises will be used for the playing of recorded music at different times from those listed above, list below:

Provision of performance of dance

Will you be providing performance of dance?: No

Provision of anything of a similar description to live music, recorded music or performances of dance

Will you be providing anything similar to live music, recorded music or performances of dance?: No

Late night refreshment

Will you be providing late night refreshment?: Yes

Which days of the week do you intent the premises to be used for the activity? Monday, Tuesday, Wednesday, Thursday, Friday, Saturday, Sunday

Give timings in 24 hour clock. (e.g., 16:00) and only give details for the days of the week when you intend the premises to be used for the activity.:

Monday:

- Start 1: 23:00
- End 1: 01:00
- Start 2:
- End 2:

Tuesday:

- Start 1: 23:00
- End 1: 01:00
- Start 2:
- End 2:

Wednesday:

- Start 1: 23:00
- End 1: 01:00
- Start 2:
- End 2:

Thursday:

- Start 1: 23:00

- End 1: 01:00
- Start 2:
- End 2:

Friday:

- Start 1: 23:00
- End 1: 01:00
- Start 2:
- End 2:

Saturday:

- Start 1: 23:00
- End 1: 01:00
- Start 2:
- End 2:

Sunday:

- Start 1: 23:00
- End 1: 01:00
- Start 2:
- End 2:

Will the provision of late night refreshment take place indoors or outdoors or both? Both
State type of activity to be authorised, if not already stated, and give relevant further details.:

State any seasonal variations:

Non standard timings. Where the premises will be used for the supply of late night refreshment at different times from those listed above, list below:

Supply of alcohol

Will you be selling or supplying alcohol?: Yes

Which days of the week do you intent the premises to be used for the activity? Monday, Tuesday, Wednesday, Thursday, Friday, Saturday, Sunday

Give timings in 24 hour clock. (e.g., 16:00) and only give details for the days of the week when you intend the premises to be used for the activity.:

Monday:

- Start 1: 17:00
- End 1: 01:00
- Start 2:
- End 2:

Tuesday:

- Start 1: 17:00
- End 1: 01:00
- Start 2:

- End 2:

Wednesday:

- Start 1: 17:00
- End 1: 01:00
- Start 2:
- End 2:

Thursday:

- Start 1: 17:00
- End 1: 01:00
- Start 2:
- End 2:

Friday:

- Start 1: 17:00
- End 1: 01:00
- Start 2:
- End 2:

Saturday:

- Start 1: 17:00
- End 1: 01:00
- Start 2:
- End 2:

Sunday:

- Start 1: 17:00
- End 1: 01:00
- Start 2:
- End 2:

Will the sale of alcohol be for consumption? On the premises

State any seasonal variations:

Non standard timings. Where the premises will be used for the supply of alcohol at different times from those listed above, list below:

Designated premises supervisor consent

Are you (as the applicant), the designated premises supervisor. Yes

How will the consent form of the proposed designated premises supervisor be supplied to the authority?:

Please upload the completed consent form for the designated premises supervisor

Do you know the reference number for the consent form

Please enter the reference number for the consent form: LD6/064352/RT2

Name of designated supervisor: Pindy Kaur

Address of designated supervisor: 93 Bruce Grove

Tottenham

N17 6UZ

Date of birth of designated supervisor: 15/06/1965

Enter the personal licence number: 64352

Issuing licensing authority: Barking and dagenham

Adult entertainment

Highlight any adult entertainment or services, activities, or other entertainment or matters ancillary to the use of the premises that may give rise to concern in respect of children.

Give information about anything intended to occur at the premises or ancillary to the use of the premises which may give rise to concern in respect of children, regardless of whether you intend children to have access to the premises: N/A

Hours premises are open to the public

Which days of the week do you intent the premises to be used for the activity? Monday, Tuesday, Wednesday, Thursday, Friday, Saturday, Sunday

Give timings in 24 hour clock. (e.g., 16:00) and only give details for the days of the week when you intend the premises to be used for the activity.:

Monday:

- Start 1: 17:00
- End 1: 01:00
- Start 2:
- End 2:

Tuesday:

- Start 1: 17:00
- End 1: 01:00
- Start 2:
- End 2:

Wednesday:

- Start 1: 17:00
- End 1: 01:00
- Start 2:
- End 2:

Thursday:

- Start 1: 17:00
- End 1: 01:00
- Start 2:
- End 2:

Friday:

- Start 1: 17:00
- End 1: 01:00
- Start 2:
- End 2:

Saturday:

- Start 1: 17:00
- End 1: 01:00
- Start 2:
- End 2:

Sunday:

- Start 1: 17:00
- End 1: 01:00
- Start 2:
- End 2:

State any seasonal variations:

Non standard timings. Where you intend to use the premises to be open to the members and guests at different times from those listed above, list below:

Licensing objectives

- a) **General – all four licensing objectives (b,c,d,e):** Experienced licence holder will endeavour to comply with the licensing objectives and will make sure staff will adequately comply and keep upto date with training
- b) **The prevention of crime and disorder:** Bruce burgers staff are trained to help the law and prevent crime and disorder. We have cctv installed covering all critical areas inside and outside, in addition we provide regular training for staff on how to handle aggressive behaviour, identify fake ID's and deal with intoxicated people. We will also only be serving alcohol as part as a meal and to adults only and making sure we comply with challenge 25
- c) **Public safety:** Regular safety checks are conducted to ensure all safety equipment such as fire extinguishers and emergency exists are in working order and accessible, we adhere to the maximum occupancy limits to prevent over crowding and to prevent any safety risks we will also implement a refusal book which will help identify any person to adhere to the public safety and prevent any nuisance or crime
- d) **The prevention of public nuisance:** We have a noise control device which prevents loud music and monitors noise levels, we also avoid advertising practices which promotes excessive drinking and more importantly we as a business engage in the community so that the communication channel with the local residents and business feel comfortable in addressing any concerns they may have regarding noise or disturbances
- e) **The protection of children from harm:** Staff will adhere to strict ID checking policy to prevent any underage drinking and sales. We are a family friendly business and kids seating will be allocated away from alcohol service points and all staff are vigilant about the presence of children and we make sure they wont be exposed to inappropriate behaviour or environments

Declaration

I/we understand it is an offence, liable on conviction to a fine up to level 5 on the standard scale, under section 158 of the licensing act 2003, to make a false statement in or in connection with this application.

[Applicable to individual applicants only, including those in a partnership which is not a limited liability partnership]

I understand I am not entitled to be issued with a licence if I do not have the entitlement to live and work in the UK (or if I am subject to a condition preventing me from doing work relating to the carrying on of a licensable activity) and that my licence will become invalid if I cease to be entitled to live and work in the UK (please read guidance note 15).

The DPS named in this application form is entitled to work in the UK (and is not subject to conditions preventing him or her from doing work relating to a licensable activity) and I have seen a copy of his or her proof of entitlement to work, if appropriate (please see note 15)

Ticking this box indicates you have read and understood the above declaration yes I agree

Declaration

Full name: Pindy Kaur

Capacity: Manager

Date: 2024-05-25

Payment summary

Amount: £190.00

Payment status: successful

Receipt number: SMYAC00289858

This page is intentionally left blank

MANTEBEA

EMAIL: GILLEN108@GMAIL.COM

BRUCE BURGERS FLOOR PLAN -
ALCOHOL LICENSE

ADDRESS: 93 BRUCE GROVE, LONDON
N17 6UZ

DATE: 27-04-2024

LEGEND:

-  - SMOKE DETECTOR
-  - FIRE DOOR/EXIT
-  - CCTV CAMERA
-  - AIR CONDITIONING
-  - FIRE EXTINGUISHER
-  - PROPOSED ALCOHOL CONSUMPTION
BACK AREA (21.27m²) / FRONT of H AREA
(14.32m²)
-  - ALCOHOL DISPLAY AREA
-  - ALCOHOL STORAGE AREA
-  - RESTAURANT DINING AREA

SCALE: 1/200 AT A3

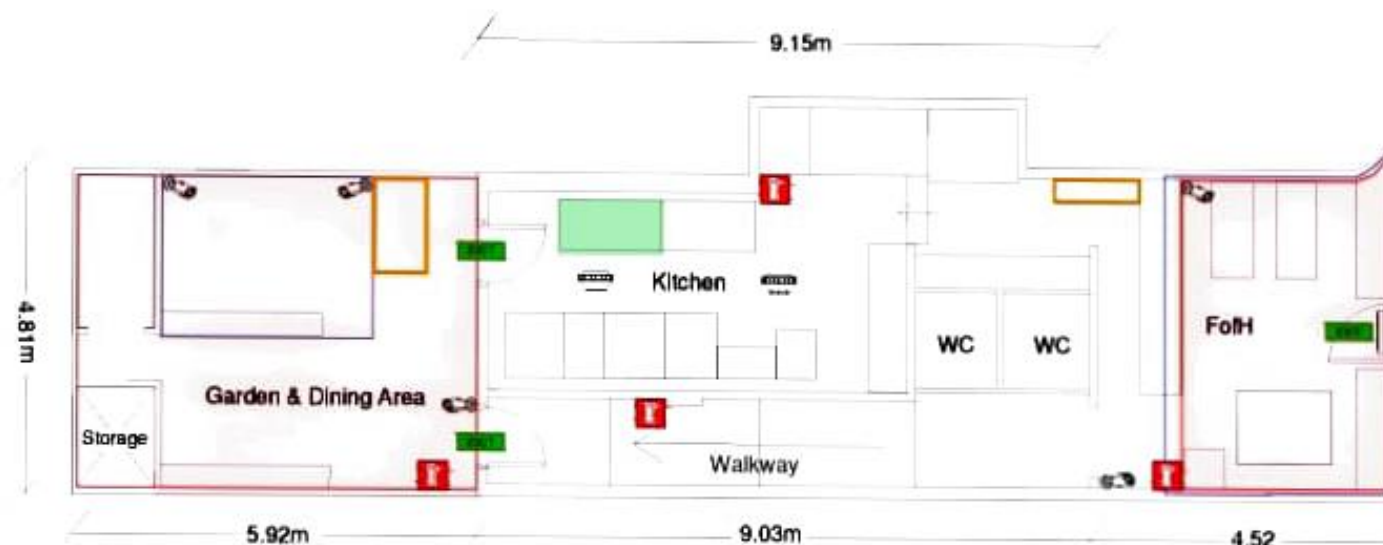

GROSS GROUND FLOOR INTERNAL AREA: 99.0171m²

RESTAURANT CAPACITY TOTAL - 45

20 IN BACK

25 IN FRONT

GROUND FLOOR PLAN



This page is intentionally left blank

Appendix B

This page is intentionally left blank



Licensing Authority
Licensing Team
4th Floor,
10 Station Road,
London
N22 7TR

Licensing Unit
Edmonton Police Station
462 Fore Street,
London
N9 0PW
PC 1277NA Ewart

www.met.police.uk

21st June 2024

Police Representation

Additional Information regarding -APPLICATION FOR A NEW PREMISES LICENCE

Bruce Burgers, 93 Bruce Grove, Tottenham, London, N17 6UZ

Dear Licensing Team,

Further to my representation submitted earlier today it has come to my attention as a result of an internet search that the premises have it appears previously shown live sporting events .The below picture was taken from the premises google profile which shows the installation of a pull down screen and what appears to be a televised dart being shown.

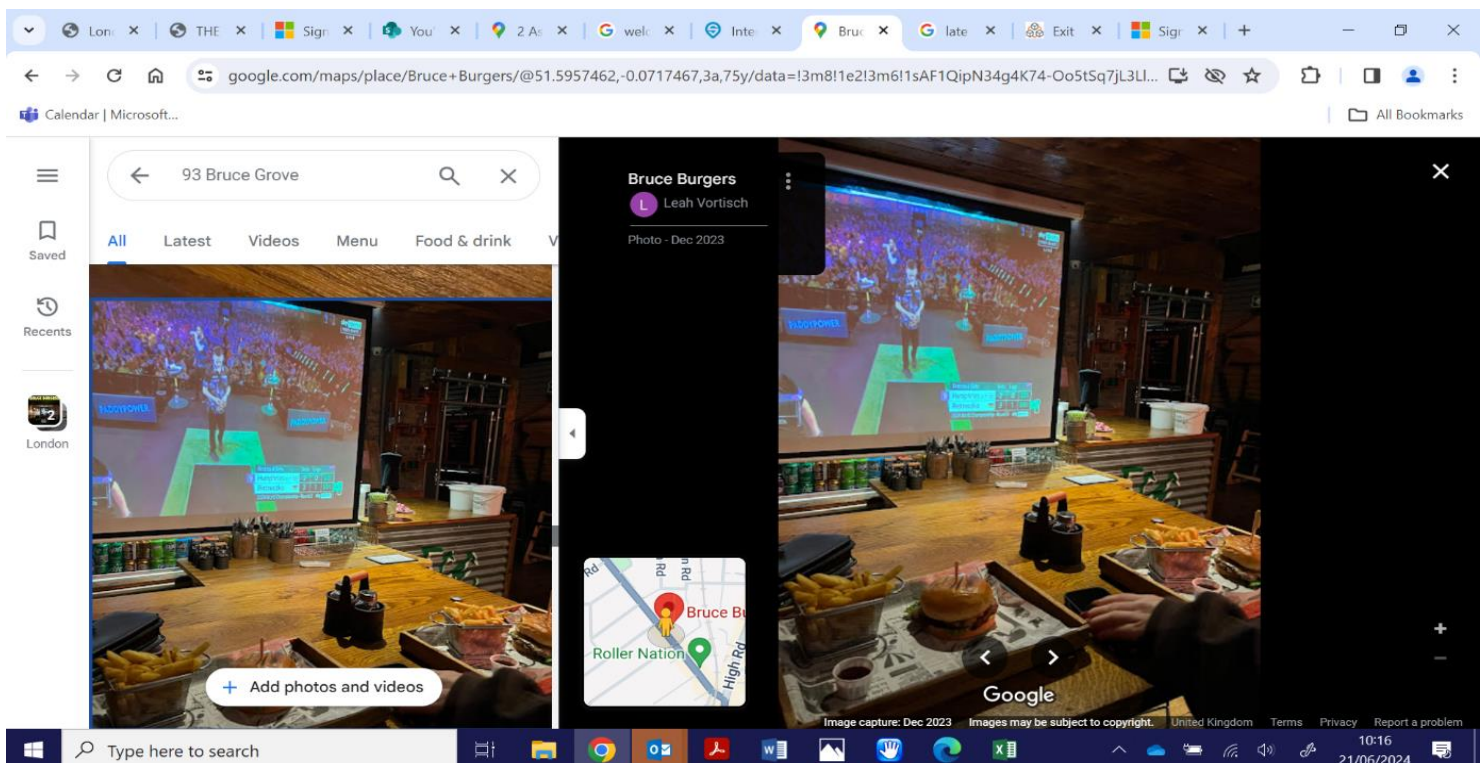

It is to be noted that such showing of sporting events attracts a certain patron type and with it will bring with it additional risks associated with a higher likelihood of public nuisance and noise from patrons enjoying the sporting events, more frequent showing of sporting events may attract a new clientele and or regular customers may choose to stay longer. This may lead to increased levels of intoxication, which could cause noise issues when using outside areas or when leaving the premises .As the application is a change to established current operations a risk assessment should have been carried out.

It is unknown what kind of sporting events in addition to darts that are being shown but we are of the opinion if football for instance is shown then this establishment would then be more akin to a sports bar the venue with all the possible issues associated with that type of establishment .

It is unknown whether the premises holds the correct commercial subscription to show live sporting events with broadcasters such as Sky or not, a valid TV Licence is also required.

It is worth noting that if the events televised are not live and are of the nature of reruns then the licensable activity of "films" would be required on the premises licence.

The additional information is in support of our position that the licensing objective of Prevention of Public Nuisance is likely to be undermined.

I reserve the right to provide further information to support this representation.

Regards, PC 1277NA Derek Ewart

North Area Licensing Officer



Licensing Authority
Licensing Team
4th Floor,
10 Station Road,
London
N22 7TR

Licensing Unit
Edmonton Police Station
462 Fore Street,
London
N9 0PW

PC 1277NA Ewart
www.met.police.uk

21st June 2024

Police Representation

APPLICATION FOR A NEW PREMISES LICENCE

Bruce Burgers, 93 Bruce Grove, Tottenham, London, N17 6UZ

Dear Licensing Team,

This application is submitted by Miss Pindy Kaur of the above business in regards to a new premises licence application additionally under the name of Bruce Burgers Ltd. The applicant is also applying to be the Designated Premises Supervisor.

This premises licence application is for a restaurant described as follows, "Bruce burgers consists of a dining area at the front of the shop which can seat up to 25 people and then a kitchen area and male and female toilets with a garden area at the rear of the restaurant which can seat up to 20 people situated within a wholly residential area with accommodation above the premises".

The premises are situated within a mainly residential area with retail shops .There are residential properties above the premises and

The police wish to make representations as we feel if the application is granted the following objectives will be undermined:

- **Prevention of Crime and Disorder**
- **Prevention of public nuisance**

The proposed times and licensable activities applied for are as follows:

Regulated Entertainment: Recorded Music	
Monday to Sunday	2300 to 0100 hours
Late Night Refreshment	
Monday to Sunday	2300 to 0100 hours
Sale of Alcohol	
Monday to Sunday	1700 to 0100 hours
Supply of alcohol ON the premises.	
Hours open to Public	
Monday to Sunday	1700 to 0100 hours

Venue

These premises as stated are located within a highly residential area which would if not guarded against and planned for in an adequate operating schedule would lead to public nuisance, Disturbance and associated anti-social behaviour issues in the form of noise nuisance and patron disturbance/Disorder.

We are in receipt of information from the local authority that your planning authority has stipulated the following hours in respect of your business (Please see below) .Your applied for hours in this application are therefore clearly outside of the hours as stipulated within the planning permission.

“The use hereby permitted shall not be operated before 08:00 or after 23:30 hours on Monday to Saturday and not before 0800 or after 2300 hours on Sundays or Bank Holidays. Reason: This permission is given to facilitate the beneficial use of the premises whilst ensuring that the amenities of adjacent residential properties are not diminished”.

Whilst under the licensing Act lack of planning permission in and of itself is not a bar to applying for a premises licence, the licensing application process cannot be used to circumvent planning law on stipulated hours.

We further note the use of the rear garden area for use by patrons ,it is our opinion that use of this area which is embedded within residential properties into the late evening and beyond would have a negative effect on the residents quiet enjoyment of their properties in the form of loss of sleep and disturbance by way of patrons some of whom will have consumed alcohol being loud and causing a general nuisance .This especially during weekday working week would impact upon residents quality of life .

The rear garden area appears extremely enclosed have you conducted a risk assessment as far as public safety is concerned? We do not have any documentation that highlights that

We object and do not support the submitted hours especially concerning the use of the rear garden area and in line with the Local Authority suggest the following hours be adopted in place of the submitted hours :

Regulated Entertainment: Recorded Music	
Monday to Sunday	Music to stop at 23:00 with the main premises.
No music permitted in the rear garden area after 21:00 on any day.	
Late Night Refreshment	
Monday to Saturday	23:00 – 23:30
Sale of Alcohol	
Monday to Saturday	1700 to 23:00 hours
Sunday	1700 to 22:30 hours
Supply of alcohol ON the premises.	
Hours open to Public	
Monday to Saturday	1700 to 23:30 hours
Sunday	1700 to 23:00 hours
The rear garden to be closed by 21:00 each day in order to ensure the prevention of public nuisance from music or people noise.	

In line and in support of the Licensing Authorities Representation we do not object to the timings however feel that the submitted operating schedule is insufficient to uphold the licensing objectives adequately and would require the following be added to the licence in order to negate the risk.

Additionally we feel that the applicants operating schedule is sparse in content and does not adequately implement conditions that would uphold the licensing objectives, to that end we

would suggest the following conditions be adopted and if the licence is granted added to it thus:

1. Prominent, clear and legible notices shall be displayed at all public exits from the premises requesting customers respect the needs of local residents and leave the premises and area quietly. These notices shall be positioned at eye level and in a location where those leaving the premises can read them.
2. The management shall make subjective assessments of noise levels outside at the perimeter of the premises at least hourly, whilst regulated entertainment is provided to ensure that noise from the premises does not cause a disturbance to local residents. Records shall be kept for one year. Records must be made available to the Police and/or Local Authority upon request. Where monitoring by staff identifies that noise from the premises is audible at the perimeter, measures shall be taken to reduce this i.e. turning volume down.
3. All external doors and windows shall be kept closed when regulated entertainment takes place, except in case of an emergency and for access/egress.
4. All refuse and bottles shall be disposed of in bins quietly so as not to disturb local residents. There shall be no disposal of glass bottles outside between 21:00 and 07:00.
5. All staff shall receive induction and refresher training (at least every three months) relating to the sale of alcohol and the times and conditions of the premises licence.
6. All training relating to the sale of alcohol and times and conditions of the premises licence, shall be documented and records kept at the premises. These records shall be made available to the Police and/or Local Authority upon request and shall be kept for at least one year.
7. Children under 14 years, not accompanied by an adult, are not permitted to remain at or enter the premises after 21:00.
8. Children under 18 years, not accompanied by an adult, are not permitted to remain at or enter the premises after 23:00.
9. The premises licence holder shall ensure that the area immediately outside the premises is kept clean and free from litter including smoking related litter at all material times to the satisfaction of the Licensing Authority.
10. An incident log shall be kept at the premises, it will be in a hardback durable format handwritten at the time of the incident or as near to as is reasonable and made available on request to the Police or Local Authority, which will record the following:
 - (a) All crimes reported to the venue;
 - (b) All ejections of patrons;
 - (c) Any complaints received;
 - (d) Any incidents of disorder;
 - (e) Seizures of drugs or offensive weapons;
 - (f) Any faults in the CCTV system or searching equipment or scanning equipment;
 - (g) Any visit by a relevant authority or emergency service.
11. Staff shall actively discourage patrons from congregating around the outside of the premises.
12. No more than 5 persons shall be permitted to smoke outside the front of the premises after 11pm. The area shall be adequately supervised to control the number and

behaviour of patrons and to ensure that they do not block the highway or cause a noise nuisance. Notices shall be displayed in the area specifying the terms of its use and asking patrons to use the area quietly.

13. A 'Challenge 25' proof of age scheme shall be operated and relevant material shall be displayed at the premises.
14. A written record of refused sales shall be kept on the premises and completed when necessary. This record shall be made available to Police and/or the Local Authority upon request and shall be kept for at least one year from the date of the last entry.
15. Alcohol shall not be brought onto the premises by customers.
16. At least three members of staff shall be on duty on the premises (in the licensed area) from 10pm until the premises has closed.
17. A digital CCTV system shall be installed in the premises complying with the following criteria:
 - (a) Cameras shall be sited to observe the entrance and exit doors both inside and outside and floor areas.
 - (b) Cameras on the entrances shall capture full frame shots of the heads and shoulders of all people entering the premises i.e. capable of identification.
 - (c) Cameras overlooking floor areas shall be wide angled to give an overview of the premises.
 - (d) Be capable of visually confirming the nature of the crime committed.
 - (e) Provide a linked record of the date, time, and place of any image.
 - (f) Provide good quality images - colour during opening times.
 - (g) Operate under existing light levels within and outside the premises.
 - (h) Have the recording device located in a secure area or locked cabinet.
 - (i) Have a monitor to review images and recorded picture quality.
 - (j) Be regularly maintained to ensure continuous quality of image capture and retention.
 - (k) Have signage displayed in the customer area to advise that CCTV is in operation.
 - (l) Digital images shall be kept for 31 days.
 - (m) Police or authorised local authority employees shall have access to images at any reasonable time.
 - (n) The equipment shall have a suitable export method, e.g., CD/DVD writer so that the police can make an evidential copy of the data they require. This data should be in the native file format, to ensure that no image quality is lost when making the copy. If this format is non-standard (i.e. manufacturer proprietary) then the manufacturer should supply the replay software to ensure that the video on the CD can be replayed by the police on a standard computer. Copies must be made available to Police or authorised local authority employees on request.

I reserve the right to provide further information to support this representation

In summary

We the Police **object** to the application on the grounds stated .It is feared that without adequate and detailed safeguards, policies and risk assessments being in place and implemented control of the premises could easily be lost and a risk posed to both patrons and the wider community as a result

If the suggested additional conditions were accepted to the operating schedule WE WOULD withdraw this representation.

I reserve the right to provide further information to support this representation.

Regards, PC 1277NA Derek Ewart

North Area Licensing Officer

Appendix C

This page is intentionally left blank

Dear Sir/Madam,

In addition to the below, the Authority is making a further amendment to ensure the Licensing objectives are observed and promoted should a Premises Licence be granted:

No placing of items on the public highway.
No grills or other cooking appliances on the public highway.

No speakers to be placed at the front entrance.

Regards
Haringey Licensing Authority

Dear Pindy Kaur,

The Licensing Authority is considering your application under the impacts on the four licensing objectives.
You are requesting the following hours :

Regulated Entertainment: Recorded Music

Monday to Sunday 2300 to 0100 hours

Late Night Refreshment

Monday to Sunday 2300 to 0100 hours

Sale of Alcohol

Monday to Sunday 1700 to 0100 hours

Supply of alcohol **ON** the premises.

Hours open to Public

Monday to Sunday 1700 to 0100 hours

Having checked the current hours granted under the Planning permission for 93 Bruce Grove the permitted hours are as follows:

- The use hereby permitted shall not be operated before 08:00 or after 23:30 hours on Monday to Saturday and not before 0800 or after 2300 hours on Sundays or Bank Holidays. Reason: This permission is given to facilitate the beneficial use of the premises whilst ensuring that the amenities of adjacent residential properties are not diminished.

Have you applied to Planning to have the hours altered to the timings you are requesting on a Premises Licence? If not, I would encourage you to do so. The Licensing process is not a substitute for any business to seek to gain later hours not granted under Planning law.

Also the current timings on the Planning permission did not include the use of the rear garden for seating customers, this has been a recent change it seems. The use of a rear external area beyond 21:00 on a weekday for instance would have a severe impact on

residents who have to live and put children to sleep or get to sleep themselves in order to face work the next day.

We note that capacity limits are shown on the plan. Do you have your risk assessment to show how the capacity figures were arrived at? Please can you submit a copy. Do you have a written fire risk assessment also as we note the people who would be utilising the rear garden will need a route or escape from the rear area if there was a fire in the kitchen area and they could not make their way out via the route they came. Can you please submit the fire risk assessment and show on the plan where the alternative means of escape from the rear area would be and where it would lead to?

From a licensing perspective consideration must be given to the prevention of nuisance objective. We are unable to support the lateness of the hours being applied for across the week and draw your attention to the Section 182 Guidance that underpins the Licensing Act 2003 with regards to hours already in existence under the Planning regime:

14.66 There are circumstances when, as a condition of planning permission, a terminal hour has been set for the use of premises for commercial purposes. Where these hours are different to the licensing hours, the applicant must observe the earlier closing time.

Moreover the hours of use being applied for the rear area that is in the midst of residential properties all around is not supported and reduced hours of use are proposed to ensure that residents and children are not unduly impacted by people or music noise from this location:

Regulated Entertainment: Recorded Music

Monday to Sunday Music to stop at 23:00 with the main premises.
 No music permitted in the rear garden area after 21:00
on any day.

Music in the rear garden to be for background only and not to be heard at the nearest residential property.

Late Night Refreshment

Monday to Saturday 23:00 – 23:30

Sale of Alcohol

Monday to Saturday 1700 to 23:00 hours
Sunday 1700 to 22:30 hours

Supply of alcohol **ON** the premises.

Hours open to Public

Monday to Saturday 1700 to 23:30 hours
Sunday 1700 to 23:00 hours

The rear garden to be closed by 21:00 each day in order to ensure the prevention of public nuisance from music or people noise.

You are encouraged to seek changes to your Planning permission if you wish to seek later hours.

Regards
Haringey Licensing Authority.

This page is intentionally left blank

Dear Pindy Kaur,

The Licensing Authority is considering your application under the impacts on the four licensing objectives.

You are requesting the following hours :

Regulated Entertainment: Recorded Music

Monday to Sunday 2300 to 0100 hours

Late Night Refreshment

Monday to Sunday 2300 to 0100 hours

Sale of Alcohol

Monday to Sunday 1700 to 0100 hours

Supply of alcohol **ON** the premises.

Hours open to Public

Monday to Sunday 1700 to 0100 hours

Having checked the current hours granted under the Planning permission for 93 Bruce Grove the permitted hours are as follows:

- The use hereby permitted shall not be operated before 08:00 or after 23:30 hours on Monday to Saturday and not before 0800 or after 2300 hours on Sundays or Bank Holidays. Reason: This permission is given to facilitate the beneficial use of the premises whilst ensuring that the amenities of adjacent residential properties are not diminished.

Have you applied to Planning to have the hours altered to the timings you are requesting on a Premises Licence? If not, I would encourage you to do so. The Licensing process is not a substitute for any business to seek to gain later hours not granted under Planning law.

Also the current timings on the Planning permission did not include the use of the rear garden for seating customers, this as been a recent change it seems. The use of a rear external area beyond 21:00 on a weekday for instance would have a severe impact on residents who have to live and put children to sleep or get to sleep themselves in order to face work the next day.

We note that capacity limits are shown on the plan. Do you have your risk assessment to show how the capacity figures were arrived at ? Please can you submit a copy. Do you have a written fire risk assessment also as we note the people who would be utilising the rear garden will need a route or escape from the rear area if there was a fire in the kitchen area and they could not make their way out via the route they came. Can you please submit the fire risk assessment and show on the plan where the alternative means of escape from the rear area would be and where it would lead to?

From a licensing perspective consideration must be given to the prevention of nuisance objective. We are unable to support the lateness of the hours being applied for across the

week and draw your attention to the Section 182 Guidance that under pins the Licensing Act 2003 with regards to hours already in existence under the Planning regime:

14.66 There are circumstances when, as a condition of planning permission, a terminal hour has been set for the use of premises for commercial purposes. Where these hours are different to the licensing hours, the applicant must observe the earlier closing time.

Moreover the hours of use being applied for the rear area that is in the midst of residential properties all around is not supported and reduced hours of use are proposed to ensure that residents and children are not unduly impacted by people or music noise from this location:

Regulated Entertainment: Recorded Music

Monday to Sunday Music to stop at 23:00 with the main premises.
No music permitted in the rear garden area after 21:00
on any day.

Music in the rear garden to be for background only and not to be heard at the nearest residential property.

Late Night Refreshment

Monday to Saturday 23:00 – 23:30

Sale of Alcohol

Monday to Saturday 1700 to 23:00 hours
Sunday 1700 to 22:30 hours

Supply of alcohol **ON** the premises.

Hours open to Public

Monday to Saturday 1700 to 23:30 hours
Sunday 1700 to 23:00 hours

The rear garden to be closed by 21:00 each day in order to ensure the prevention of public nuisance from music or people noise.

You are encouraged to seek changes to your Planning permission if you wish to seek later hours.

Regards
Haringey Licensing Authority.

Dear Pindy,

I am processing your application for a premises licence. Under the four licensing objectives I want to put a couple of conditions on the licence. These are conditions that are put on the majority of premises, especially those that have an outside area.

Please let me know if you are in agreement with these conditions.

Public Nuisance:

- No noise generated on the premises, or by its associated plant or equipment, shall emanate from the premises nor vibration be transmitted through the structure of the premises which gives rise to a nuisance.
- All windows, external doors and retractable roofs shall be kept closed after (22:00) hours when regulated entertainment takes place, except for the immediate access and egress of persons.
- The use of the garden is prohibited after 2200 hours. All patrons must vacate the garden seating area and be seated inside the main part of the restaurant.
- Any music played must be played at background level only.
- Notices shall be prominently displayed at all exits requesting patrons to respect the needs of local residents and businesses and leave the area quietly.
- A direct telephone number for the manager at the premises shall be publicly available at all times the premises is open. This telephone number and is to be made available to residents and businesses in the vicinity.

Kind regards

April Smart
Noise and Nuisance Officer



Haringey London

www.haringey.gov.uk
[twitter@haringeycouncil](https://twitter.com/haringeycouncil)
facebook.com/haringeycouncil

 Please consider the environment before printing this email.

This page is intentionally left blank

Appendix D

This page is intentionally left blank

App D

From: Lorraine Gabbidon <
Sent: Tuesday, June 25, 2024 11:47 AM
To: Licensing <licensing@haringey.gov.uk>
Cc:
Subject: Bruce Burgers - Support

To whom it may concern,

We are writing in support of Bruce Burgers, 93 Bruce Grove Road, London N17 6UZ.

Since the restaurant opened up it has brought a welcoming family atmosphere and presence to the community. It is somewhere that both local residents and customers from afar can come together and enjoy a tasty meal and refreshments. The establishment has a lovely garden area where customers can sit outside in the fresh air and enjoy their meal and drinks in a safe environment which is very rare in this area. My family love going there, the staff are amazing and always very friendly and greet you with a smile.

We live just behind the restaurant with our garden just a few yards from the Bruce Burgers garden and have never experienced any issues at all.

We strongly believe that Bruce Burgers should be able to continue with what they have brought to the community, to have the garden use beyond 10pm and alcoholic drinks with the meals.

We hope you take our feedback into consideration.

Kind Regards,

Darren Woolcock (and family) -

This page is intentionally left blank

Appendix E

This page is intentionally left blank

Premises Licence- Bruce Burgers Residential Representation list 1

From: [REDACTED]
Sent: Thursday, June 13, 2024 9:16 AM
To: Licensing <licensing@haringey.gov.uk>
Subject: Objection to Application for 2 AM Alcohol Licence

Dear Sir/Madam,

I am writing to formally object to the application for an alcohol licence at two neighbouring venues Milk Treatz and Bruce Burgers, the former which proposes serving alcohol until 2 AM.

As a resident of this area, I have serious concerns about the negative impact this licence would have on our community. Firstly, the late-night operation of this venue already causes significant nuisance to residents. Past experience has shown that people leaving such establishments create a considerable amount of noise, which disrupts the peace and quiet of our neighbourhood. The disturbances frequently continue well past closing time (2am), making it difficult for residents to sleep and affecting their overall quality of life. Additionally, there has been a noticeable increase in litter around the area, from patrons of local late-night venues. This includes not only general rubbish, wrappers, food, boxes but also broken bottles and other hazardous waste. The increase in litter not only detracts from the appearance of our neighbourhood but also poses a safety risk to children and pets. It's also a costly expense for the council with street cleaners constantly needed to clear the area. I believe Milk Treatz has previously been fined by Haringey for litter.

Moreover, there have been several instances of crime in the vicinity, which seem to correlate with the times when such venues are open. I myself have made two calls to police due to crime/safety.

This includes petty crimes, such as vandalism and theft, as well as more serious issues. There is also a disturbing trend of drug use and dealing occurring on residential street that correlates with the late opening times. This has created an unsafe environment and has caused significant anxiety among residents, particularly those with young families. The extension of the alcohol licence to 2 AM will likely exacerbate these problems. The presence of intoxicated individuals in the early hours of the morning increases the risk of anti-social behaviour and crime, making the neighbourhood less safe for everyone.

I urge the council to consider the well-being of its residents and the potential negative impact on our community when making a decision on this application. The peace and safety of our residential area should be a priority over the extended operating hours of a single venue. Thank you for your attention to this matter. I hope you will take our concerns seriously and deny the application for this late-night alcohol licence to both venues

Yours faithfully,

[REDACTED]

[REDACTED]

[REDACTED]

[REDACTED]

From: [REDACTED]
Sent: Thursday, June 13, 2024 9:28 AM
To: Licensing <licensing@haringey.gov.uk>
Subject: Feedback on licensing application for Milk Treatz and Bruce Burgers

Dear Sir/Madam,

I am writing to formally object to the application for an alcohol licence at two neighbouring

venues Milk Treatz and Bruce Burgers, the former which proposes serving alcohol until 2 AM.

As a resident of this area, I have serious concerns about the negative impact this licence would have on our community.

Firstly, the late-night operation of this venue already causes significant nuisance to residents. Past experience has shown that people leaving such establishments create a considerable amount of noise, which disrupts the peace and quiet of our neighbourhood. The disturbances frequently continue well past closing time (2am), making it difficult for residents to sleep and affecting their overall quality of life.

Secondly, there has been a noticeable increase in litter around the area, from patrons of local late-night venues. This includes not only general rubbish, wrappers, food, boxes but also broken bottles and other hazardous waste. The increase in litter not only detracts from the appearance of our neighbourhood but also poses a safety risk to children and pets. It's also a costly expense for the council with street cleaners constantly needed to clear the area. I believe Milk Treatz has previously been fined by Haringey for litter.

Third, there have been several instances of crime in the vicinity, which seem to correlate with the times when such venues are open. I myself have made two calls to police due to crime/safety. This includes petty crimes, such as vandalism and theft, as well as more serious issues. There is also a disturbing trend of drug use and dealing occurring on residential street that correlates with the late opening times. This has created an unsafe environment and has caused significant anxiety among residents, particularly those with young families.

The extension of the alcohol licence to 2 AM will likely exacerbate these problems. The presence of intoxicated individuals in the early hours of the morning increases the risk of anti-social behaviour and crime, making the neighbourhood less safe for everyone.

I urge the council to consider the well-being of its residents and the potential negative impact on our community when making a decision on this application. The peace and safety of our residential area should be a priority over the extended operating hours of a single venue.

Thank you for your attention to this matter. I hope you will take our concerns seriously and deny the application for this late-night alcohol licence to both venues

Yours faithfully,

[REDACTED]

[REDACTED]

From: [REDACTED]

Sent: Monday, June 17, 2024 3:23 PM

To: Licensing <Licensing.Licensing@haringey.gov.uk>

Subject: Re: Objection to Late Licence/ Milk Treatz and Bruce Burgers

Your welcome

[REDACTED]

[REDACTED]

[REDACTED]

Attaching evidence this morning of the aftermath of the weekend of the two places seeking licensing, this

is is just one morning from the rubbish.

Best Wishes

[REDACTED]





From: [REDACTED]
Sent: Thursday, June 13, 2024 10:18 AM
To: Licensing <licensing@haringey.gov.uk>
Subject: Objection to Late Licence

Dear Sir/Madam,

I am writing to formally object to the application for an alcohol licence at two neighbouring venues Milk Treatz and Bruce Burgers, the former which proposes serving alcohol until 2 AM.

639 High Road, Tottenham, N178AA
88 Bruce Grove, Tottenham, N176UZ

I am a personal license holder. I can see in Hackney that they have restricted late licences after 11pm for the reason that Hackney is very residential. For Parity Haringey should also follow suit. Tottenham is a highly residential area and thus ANY license granted past 11pm seems inappropriate for new ventures / venues / business.

As a resident of this area, I have serious concerns about the negative impact this licence would have on our community. Firstly, the late-night operation of this venue already causes significant nuisance to residents. Past experience has shown that people leaving such establishments create a considerable amount of noise, which disrupts the peace and quiet of our neighbourhood. The disturbances frequently continue well past closing time (2am), making it difficult for residents to sleep and affecting their overall quality of life. Additionally, there has been a noticeable increase in litter around the area, from patrons of local late-night venues. This includes not only general rubbish, wrappers, food, boxes but also broken bottles and other hazardous waste. The increase in litter not only detracts from the appearance of our neighbourhood but also poses a safety risk to children and pets. It's also a costly expense for the council with street cleaners constantly needed to clear the area. I believe Milk Treatz has previously been fined by Haringey for litter.

Moreover, there have been several instances of crime in the vicinity, which seem to correlate with the times when such venues are open. I myself have made two calls to police due to crime/safety.

This includes petty crimes, such as vandalism and theft, as well as more serious issues. There is also a disturbing trend of drug use and dealing occurring on residential street that correlates with the late opening times. This has created an unsafe environment and has caused significant anxiety among residents, particularly those with young families. The extension of the alcohol licence to 2 AM will likely exacerbate these problems. The presence of intoxicated individuals in the early hours of the morning increases the risk of anti-social behaviour and crime, making the neighbourhood less safe for everyone.

I urge the council to consider the well-being of its residents and the potential negative impact on our community when making a decision on this application. The peace and safety of our residential area should be a priority over the extended operating hours of a single venue. Thank you for your attention to this matter. I hope you will take our concerns seriously and deny the application for this late-night alcohol licence to both venues

Yours faithfully

[REDACTED]

This page is intentionally left blank

Appendix F

This page is intentionally left blank

APP F

From: Fatema Begum (Place & Sustainability) <
Sent: Thursday, June 6, 2024 2:17 PM
To: Licensing <Licensing.Licensing@haringey.gov.uk>
Subject: FW: Application for a Premises Licence- Bruce Burgers, 93 Bruce Grove, Tottenham, London, N17 6UZ (Ref: WK/602261)

Dear Licensing

There is no enforcement case currently logged against this address.

Hvang checked the planning history, in 1999 permission was granted to use as a restaurant/takeaway, the following are the operating hours allowed:

2. The use hereby permitted shall not be operated before 08:00 or
after 23:30 hours on Monday to Saturday and not before 0800 or
after 2300 hours on Sundays or Bank Holidays.

Reason: This permission is given to facilitate the beneficial use
of the premises whilst ensuring that the amenities of adjacent
residential properties are not diminished.

If the proposed hours on the License application differ, then the applicant is advised to seek planning permission to change the hours or risk enforcement action.

Regards

Fatema Begum
Principal Planning Officer
Placemaking and Housing, London Borough of Haringey
6th Floor, River Park House
225 High Road
Wood Green, London
N22 8HQ
Monday to Thursday only.

This page is intentionally left blank